

FORM NO 1.

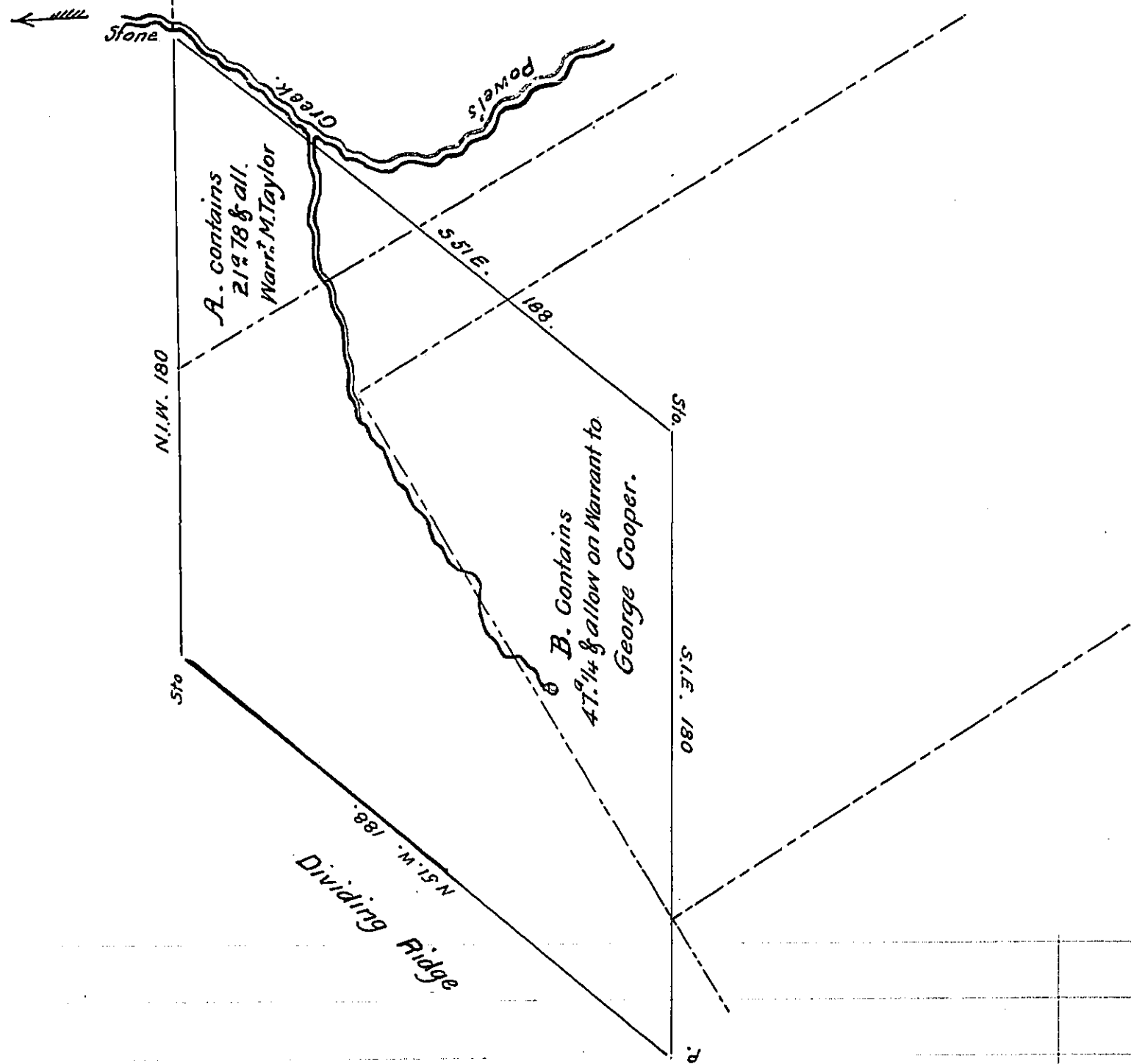

Surveyed July 11. 1833. on Warrant to Lewis Lewis dated June 10. 1774. Situate on the waters of Powels. Creek: Halifax township Dauphin County Containing two hundred acres and the usual allowance. ~

To Jacob Spangler Esq: }
 Surveyor Gen: } John Davies Contractor

Note. ~ The part marked A. contains twenty one acres Seventy eight perches and allowance now Patented and owned by Mathew Taylor on his warrant of 3^d. May 1804 ~ The part marked B. contains 47 1/4 & allowance. Surveyed on a Warrant granted to ~~Joshua~~ George Cooper dated 14th day of February 1785. ~

Taylor Pat^d J.D.
 Cooper "

IN TESTIMONY that the above is a copy of the original remaining on file in the Department of Internal Affairs of Pennsylvania, made conformably to an Act of Assembly approved the 16th day of February, 1833, I have hereunto set my Hand and caused the Seal of said Department to be affixed at Harrisburg, this thirtieth day of January 1909.

Henry Howell
 Secretary of Internal Affairs.